

Wall Construction Preparation

Butt Hinges

Timber Stud Partitioning

- SPEC 1:
 - Double Stud
 - Single Skin Plasterboard
 - Butt Hinge

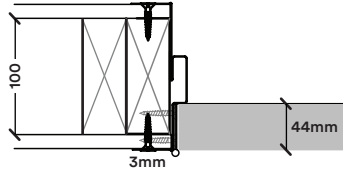

- SPEC 2:
 - Double Stud
 - Double Skin Plasterboard
 - Butt Hinge

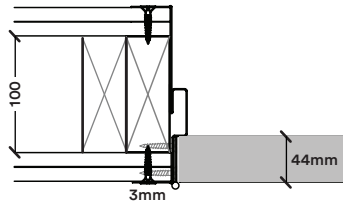

Steel Stud Partitioning

- SPEC 1:
 - Double Stud
 - Timber Stud Insert
 - Single Skin Plasterboard
 - Butt Hinge

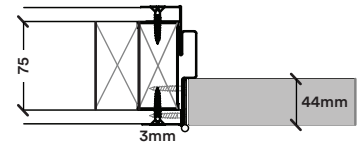

- SPEC 2:
 - Double Stud
 - Timber Stud Insert
 - Double Skin Plasterboard
 - Butt Hinge

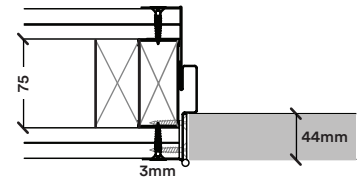

Concealed Hinges

Timber Stud Partitioning

- SPEC 1:
 - Double Stud
 - Single Skin Plasterboard
 - RocYork Concealed Hinge

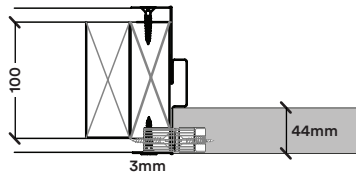

- SPEC 2:
 - Double Stud
 - Double Skin Plasterboard
 - RocYork Concealed Hinge

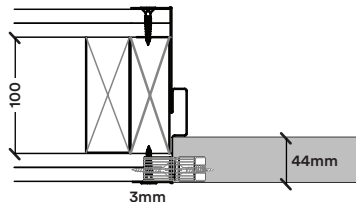

Steel Stud Partitioning

- SPEC 1:
 - Double Stud
 - Timber Stud Inserts
 - Single Skin Plasterboard
 - RocYork Concealed Hinge

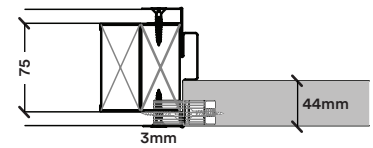

- SPEC 2:
 - Double Stud
 - Timber Stud Inserts
 - Double Skin Plasterboard
 - RocYork Concealed Hinge

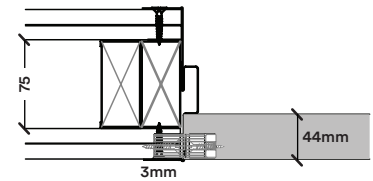

Wall Construction Preparation

Masonry Wall Construction

If EzyJamb is being used on a masonry wall then a timber stud is required within the opening. Once this has been fitted, the wall can be clad with plasterboard using the dol & dab method by fixing the plasterboard to the wall with plasterboard adhesive, or by battering cut the wall using steel or timber batten/furring. This allows the EzyJamb frame to be installed in the standard way.

- Dot & Dabbed Wall 1:
- Double Timber Stud
 - Single Skin Plasterboard
 - RocYork Concealed Hinge

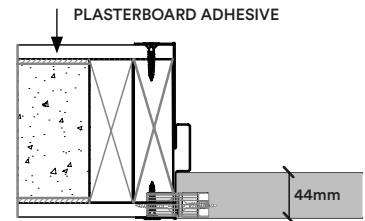

- Dot & Dabbed Wall 2:
- Double Timber Stud
 - Single Skin Plasterboard
 - Butt Hinge

